

ORDINANCE NUMBER 70139

**BOARD BILL NO. 47 INTRODUCED BY ALDERMAN ANTONIO FRENCH**

1 An Ordinance recommended by the Planning Commission on April 1, 2015, to  
2 change the zoning of property as indicated on the District Map, from “A” Single-Family  
3 Dwelling District to the “F” Neighborhood Commercial District, in City Block 4403.25  
4 (4433 Marcus Avenue), so as to include the described parcels of land in City Block  
5 4403.25; and containing an emergency clause.

6 **BE IT ORDAINED BY THE CITY OF ST. LOUIS AS FOLLOWS:**

7 **SECTION ONE.** The zoning designation of certain real property located in City  
8 Block 4403.25 is hereby changed to the “F” Neighborhood Commercial District, real  
9 property being particularly described and shown in Exhibit A as follows:

10 A tract of land in Sexauer’s 1<sup>ST</sup> Addition (private) Hutchison 2<sup>ND</sup> Subdivision in  
11 the Shreve Tract, U.S. Survey 422, being Lot 63 in Block 4403-AE of the City of St.  
12 Louis, Missouri and being more particularly described as follows;

13 Beginning at the most southerly corner of Lot 63 in Block 4403-AE, said point  
14 being on the northwesterly line of Marcus Avenue; Thence leaving said northwesterly  
15 line along the southwesterly line of Lot 63, North 41 degrees 46 minutes 20 seconds  
16 West 132.37 feet to a point on a 15 feet wide alley line; Thence along said alley line,  
17 North 48 degrees 50 minutes 21 seconds East 30 feet to the most northerly corner of said  
18 Lot 63; thence leaving said alley line, South 41 degrees 46 minutes 20 seconds East  
19 132.36 feet to a point on aforementioned northwesterly line of Marcus Avenue; Thence  
20 along said northwesterly line, South 48 degrees 49 minutes 14 seconds West 30 feet back  
21 to the Point of Beginning. Address 4433 Marcus Avenue Parcel 44032501300.

ORDINANCE NUMBER 70139

1           **SECTION 2.** This ordinance being necessary for the preservation of the health,  
2 safety and welfare shall take effect and be in full force immediately upon approval by the  
3 Mayor of the City of St. Louis.

# EXHIBIT A DISTRICT MAP

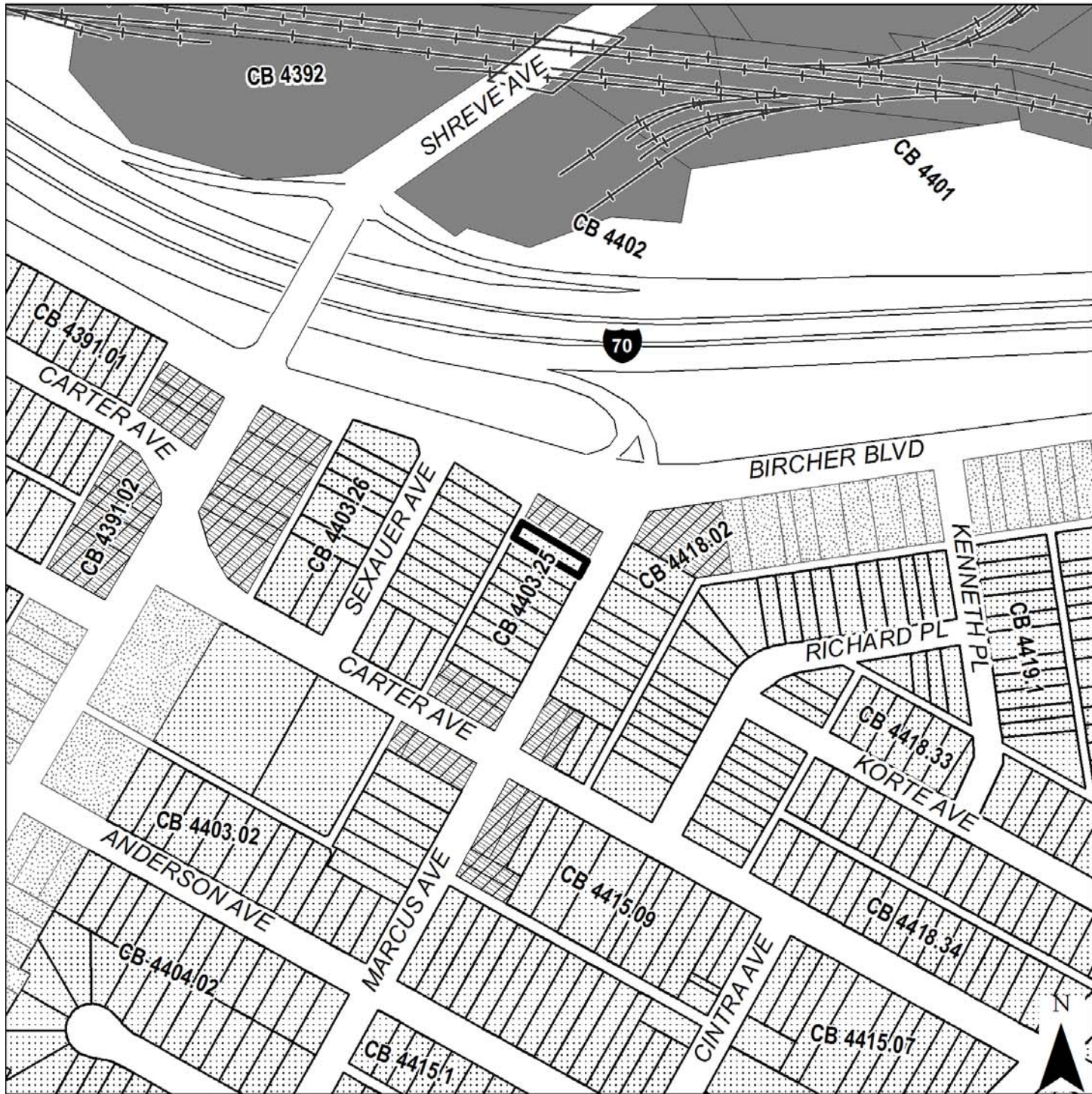

## Current Zoning District

|  |                                     |  |                               |
|--|-------------------------------------|--|-------------------------------|
|  | A Single-Family Dwelling District   |  | G Local Commercial District   |
|  | B Two-Family Dwelling District      |  | H Area Commercial District    |
|  | C Multiple-Family Dwelling District |  | I Central Business District   |
|  | D Multiple-Family Dwelling District |  | J Industrial District         |
|  | E Multiple-Family Dwelling District |  | K Unrestricted District       |
|  | F Neighborhood Commercial District  |  | L Jefferson Memorial District |

Rezoning Area

Rezoning from  
"A" to "F"

PDA-148-15-REZ