

**ORDINANCE 71227**

**BOARD BILL NUMBER 62 INTRODUCED BY: ALDERMAN JEFFREY BOYD**

1 An Ordinance recommended by the Planning Commission on June 3, 2020, to  
2 change the zoning of property as indicated on the District Map, from the “B” Two-Family  
3 Dwelling District to the “F” Neighborhood Commercial District, in City Block 3833.18  
4 (1297 Amherst Place), so as to include the described parcel of land in City Block 3833.18;  
5 and containing an emergency clause.

6 **BE IT ORDAINED BY THE CITY OF ST. LOUIS AS FOLLOWS:**

7 **SECTION ONE.** The zoning designation of certain real property located in City  
8 Block 3833.18 is hereby changed to the “F” Neighborhood Commercial District, real  
9 property being particularly described and shown in **Exhibit A** as follows:

10 A tract of land located in City Block 3833 W, St. Louis City, Missouri and further  
11 described as follows:

12 Beginning at a point being the northern most corner of lot 15 of Amherst Place as  
13 shown in the surveyor record Book 8, Pages 106 & 107 of the St. Louis City records,  
14 Said point is also in the centerline of a 12-foot wide private alley; thence continuing  
15 south 55 degrees, 33 minutes, 27 seconds east a distance of 110.95 feet to a cut cross on  
16 the sidewalk at the northeast corner of lot 17 of Amherst Place as shown in the Surveyor  
17 Record Book 8, Pages 106 & 107 of the St. Louis City records; thence along the west line  
18 of Amherst Place (40’ Wide) right-of-way and the east line of Amherst Place subdivision  
19 south 34 degrees, 21 minutes, 25 seconds west a distance of 78.25 feet to a point, said  
20 point also being the north line of lot 15 of Amherst Place Subdivision north 55 degrees,

1 33 minutes, 27 seconds west a distance of 110.95 feet to the point of beginning and  
2 containing 8,682 square feet or 0.20 acres and being subject to deeds easements and  
3 restrictions of record.



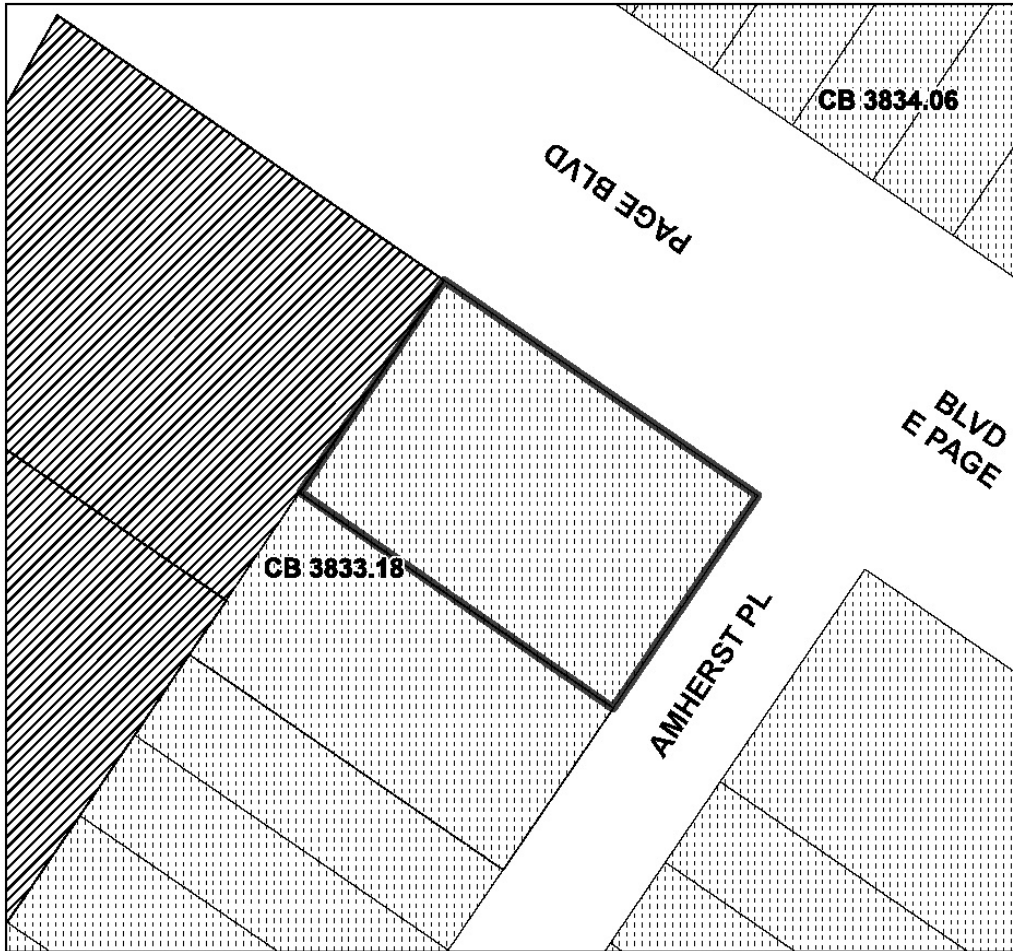

4 **SECTION TWO.** This ordinance being necessary for the preservation of the  
5 health, safety and welfare shall take effect and be in full force immediately upon approval  
6 by the Mayor of the City of St. Louis.

# EXHIBIT A

## DISTRICT MAP



### Current Zoning District

-  A Single Family Dwelling District
-  B Two-Family Dwelling District
-  C Multiple Family Dwelling District
-  D Multiple Family Dwelling District
-  E Multiple Family Dwelling District

-  F Neighborhood Commercial District
-  G Local Commercial & Office District
-  H Area Commercial District
-  I Central Business District
-  J Industrial District
-  K Unrestricted District
-  L Jefferson Memorial District

 Rezoning Area

1294 Amherst Place

PDA-045-20-REZ

CITY OF ST. LOUIS  
**PLANNING**  
 & URBAN DESIGN  
 AGENCY