

BOARD BILL NO. 162 INTRODUCED BY ALDERWOMAN CHRISTINE INGRASSIA

1 An Ordinance recommended by the Planning Commission on October 1, 2014, to
2 change the zoning of property as indicated on the District Map, from “C” Multiple-
3 Family Dwelling District to the “B” Two-Family Dwelling District, in City Block 1426
4 (2842 Magnolia), so as to include the described parcels of land in City Block 1426; and
5 containing an emergency clause.

6 **BE IT ORDAINED BY THE CITY OF ST. LOUIS AS FOLLOWS:**

7 **SECTION ONE.** The zoning designation of certain real property located in City
8 Block 1426 is hereby changed to the “B” Two-Family Dwelling District, real property
9 being particularly described and shown in Exhibit A as follows:

10 Lots 30 and 31 in Block 16 of LABADIE AND LYNCH’S ADDITION, and in
11 BLOCK 1426 of the City of St. Louis, fronting 50 feet on the South line of MAGNOLIA
12 AVENUE, by a depth Southwardly of 141 feet 4-1/2 inches to an alley.

13 **SECTION 2.** This ordinance being necessary for the preservation of the health,
14 safety and welfare shall take effect and be in full force immediately upon approval by the
15 Mayor of the City of St. Louis.

EXHIBIT A DISTRICT MAP

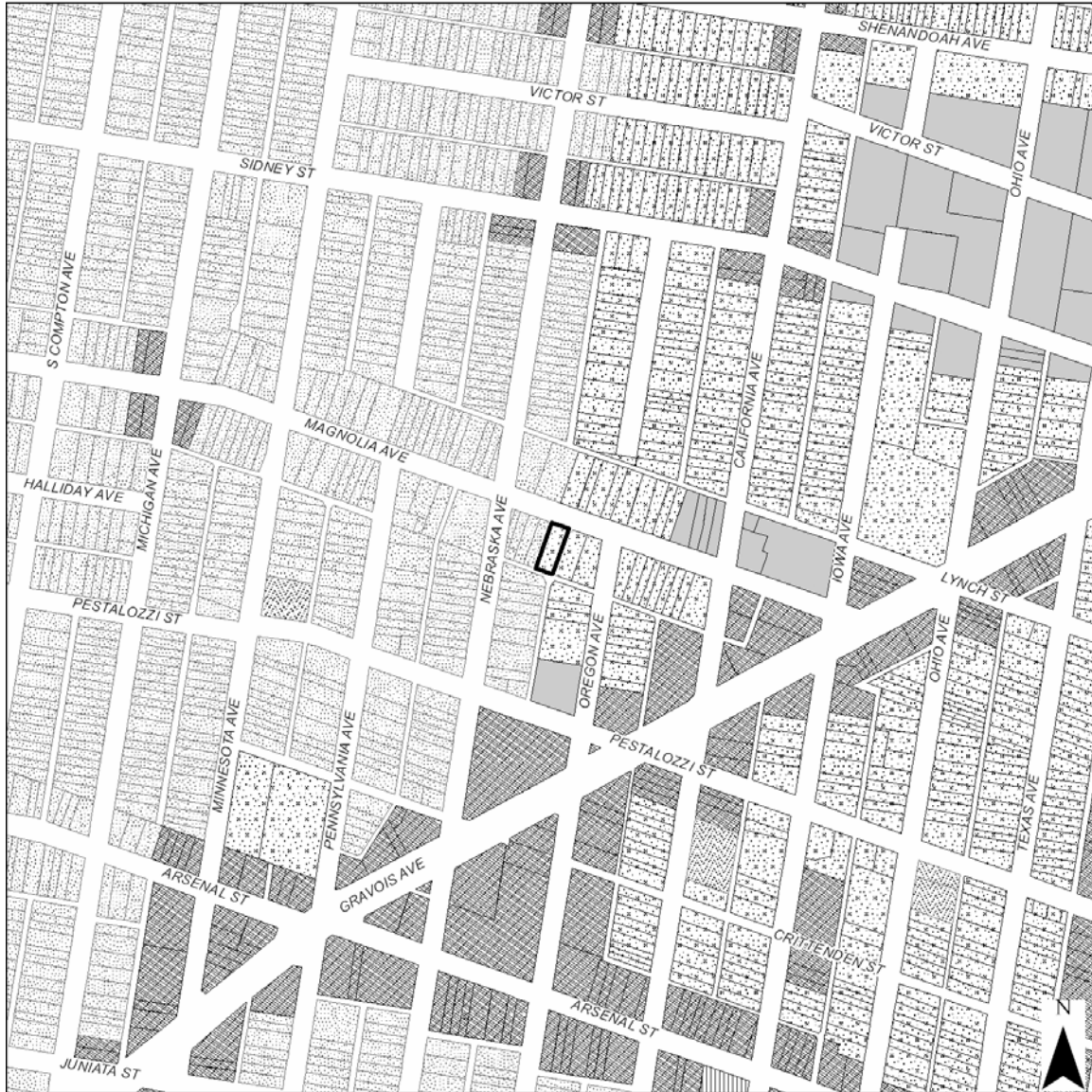

Current Zoning District

- | | | | |
|--|-------------------------------------|--|-------------------------------|
| | A Single-Family Dwelling District | | G Local Commercial District |
| | B Two-Family Dwelling District | | H Area Commercial District |
| | C Multiple-Family Dwelling District | | I Central Business District |
| | D Multiple-Family Dwelling District | | J Industrial District |
| | E Multiple-Family Dwelling District | | K Unrestricted District |
| | F Neighborhood Commercial District | | L Jefferson Memorial District |

Rezoning Area

Rezoning from
"C" to "B"

PDA-124-14-REZ

