

Summary

Board Bill Number 2

Primary Sponsor: Alderman Joseph Roddy

May 1, 2020

An Ordinance recommended by the Planning Commission on April 1, 2020, to change the zoning of property as indicated on the District Map and in City Block 4969, from “D” Multiple-Family Dwelling District and “F” Neighborhood Commercial District to the “D” Multiple-Family Dwelling District, at 4172 and 4178 Folsom Avenue, so as to include the described parcels of land in City Block 4969; and containing an emergency clause.

BOARD BILL NUMBER 2 INTRODUCED BY: ALDERMAN JOSEPH D. RODDY

1 An Ordinance recommended by the Planning Commission on April 1, 2020, to
2 change the zoning of property as indicated on the District Map and in City Block 4969,
3 from “D” Multiple-Family Dwelling District and “F” Neighborhood Commercial District
4 to the “D” Multiple-Family Dwelling District, at 4172 and 4178 Folsom Avenue, so as to
5 include the described parcels of land in City Block 4969; and containing an emergency
6 clause.

7 **BE IT ORDAINED BY THE CITY OF ST. LOUIS AS FOLLOWS:**

8 **SECTION ONE.** The zoning designation of certain real property located in City
9 Block 4969 is hereby changed to the “D” Multiple-Family Dwelling District, real
10 property being particularly described and shown in **Exhibit A** as follows:

11 Parcel 12- 4172 Folsom Avenue:

12 The Western ½ of Lot No.31 and the Eastern ½ of Lot No.32 of Dundee Place and in
13 Block No.4969 of the City of St. Louis, Fronting 40 feet on the South line of Folsom
14 Avenue, by a depth Southwardly of 128 feet to an alley, EXCEPTING THEREFROM,
15 that portion of Lot No.31 now know as Lot “C” of Botanical Heights Phase 2 – Plat 1 in
16 City Block 4969 of the City of St. Louis according to the plat thereof recorded in Plat
17 Book 01282014 page 0045 of the St. Louis City Records.

18 Parcel 13 – 4178 Folsom Avenue:

19 The Western ½ of Lot No.32 of Dundee Place and in Block No.4969 of the City of
20 St.Louis, fronting 25 feet on the South line of Folsom Avenue, by a depth Southwardly of
21 128 feet to an alley.

1 **SECTION 2.** This ordinance being necessary for the preservation of the health, safety
2 and welfare shall take effect and be in full force immediately upon approval by the
3 Mayor of the City of St. Louis.

EXHIBIT A
DISTRICT MAP

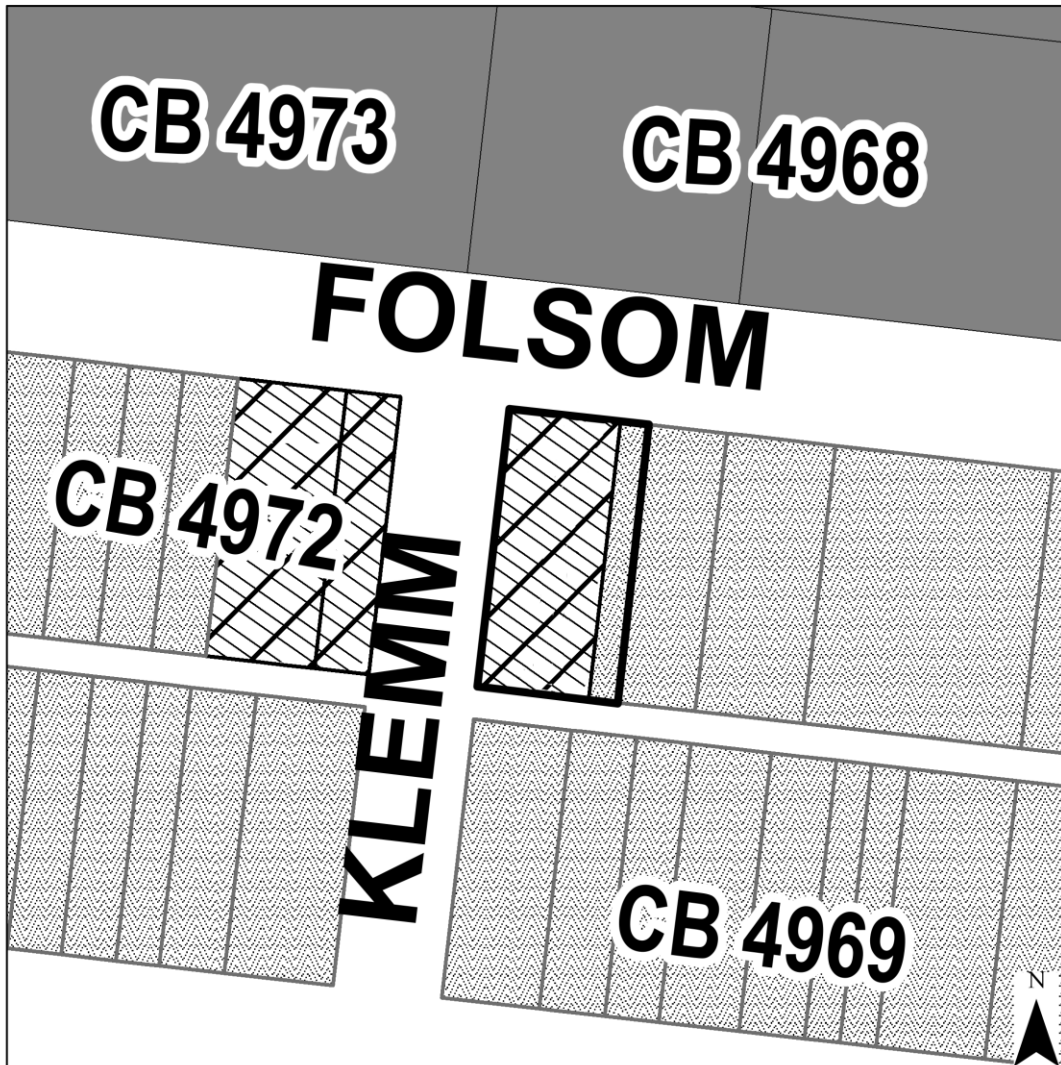

Current Zoning District

- | | | | |
|--|-------------------------------------|--|-------------------------------|
| | A Single-Family Dwelling District | | G Local Commercial District |
| | B Two-Family Dwelling District | | H Area Commercial District |
| | C Multiple-Family Dwelling District | | I Central Business District |
| | D Multiple-Family Dwelling District | | J Industrial District |
| | E Multiple-Family Dwelling District | | K Unrestricted District |
| | F Neighborhood Commercial District | | L Jefferson Memorial District |

Rezoning Area

4172 & 4178 Folsom Ave

PDA-033-20-REZ

Rezone from "F" & "F"/"D"
to "D"

