

ORDINANCE #68367
Board Bill No. 29

An ordinance approving a blighting study and redevelopment plan dated March 24, 2009 for the 2900 Cherokee St. Redevelopment Area ("Plan") after finding that said Redevelopment Area ("Area") is blighted as defined in Section 99.320 of the Revised Statutes of Missouri, 2000, as amended (the "Statute" being Sections 99.300 to 99.715 inclusive, as amended); containing a description of the boundaries of the Area in the City of St. Louis ("City"), attached hereto and incorporated herein as Attachment "A", finding that redevelopment and rehabilitation of the Area is in the interest of the public health, safety, morals and general welfare of the people of the City; approving the Plan attached hereto and incorporated herein as Attachment "B", pursuant to Section 99.430; finding that there is a feasible financial plan for the development of the Area which affords maximum opportunity for development of the Area by private enterprise; finding that no property in the Area may be acquired by the Land Clearance for Redevelopment Authority ("LCRA") of the City of St. Louis, a public body corporate and politic created under Missouri law, through the exercise of eminent domain; finding that none of the property within the Area is occupied, but if should become occupied the Redeveloper shall be responsible for relocating any eligible occupants displaced as a result of implementation of the Plan; finding that financial aid may be necessary to enable the Area to be redeveloped in accordance with the Plan; finding that there shall be available up to ten (10) year real estate tax abatement; and pledging cooperation of this St. Louis Board of Aldermen ("Board") and requesting various officials, departments, boards and agencies of the City to cooperate and to exercise their respective powers in a manner consistent with the Plan.

WHEREAS, by reason of the predominance of defective or inadequate street layout, insanitary or unsafe conditions, deterioration of site improvements, improper subdivision or obsolete platting, or the existence of conditions which endanger life or property by fire and other causes, or any combination of such factors, retards the provision of housing accommodations or constitutes an economic or social liability or a menace to the public health, safety, morals or welfare in the present condition and use of the Area; and

WHEREAS, this board has considered the "Blighting Study and Redevelopment Plan for the 2900 Cherokee St. Redevelopment Area" dated March 24, 2009, consisting of a Title Page; a Table of Contents Page, fifteen (15) numbered pages including Exhibits "A" – "F" attached hereto and incorporated herein as Attachment "B" ("Plan"); and based on the information in the Plan, specifically the Blighting Report in Exhibit "F" to the Plan, considered each parcel of property in the Area and found the preponderance of the Area to be blighted, and

WHEREAS, such conditions are beyond remedy and control solely by regulatory process in the exercise of the police power and cannot be dealt with effectively by ordinary private enterprise without the aids provided in the Statute; and

WHEREAS, there is a need for the LCRA to undertake the redevelopment of the Area as a land clearance project under the Statute, pursuant to plans by or presented to the LCRA under Section 99.430.1 (4); and

WHEREAS, the LCRA has, after considering each individual parcel of property in the Area and finding the Area to be blighted, approved the Plan and recommended approval of the Plan to the Planning Commission of the City of St. Louis ("Planning Commission") and to this Board; and;

WHEREAS, it is desirable and in the public interest that a public body, the LCRA, undertake and administer the Plan; and

WHEREAS, the LCRA and the Planning Commission have made and presented to this Board the studies and statements required to be made and submitted by Section 99.430 and this Board has been fully apprised by the LCRA and the Planning Commission of the facts and is fully aware of the conditions in the Area; and

WHEREAS, the Plan has been presented and recommended by LCRA and the Planning Commission to this Board for review and approval; and

WHEREAS, a general plan has been prepared and is recognized and used as a guide for the general development of the City and the Planning Commission has advised this Board that the Plan conforms to that general plan; and

WHEREAS, under the provisions of the Statute, it is required that this Board take such actions as may be required to approve the Plan; and

WHEREAS, this Board has duly considered the reports, recommendations and certifications of the LCRA and the Planning Commission; and

WHEREAS, the Plan prescribes land use and street and traffic patterns which may require, among other things, the vacation of public rights-of-way, the establishment of new street and sidewalk patterns or other public actions; and

WHEREAS, this Board is cognizant of the conditions which are imposed on the undertaking and carrying out of a redevelopment project, including those relating to prohibitions against discrimination because of race, color, creed, national origin, sex, marital status, age, sexual orientation or physical handicap; and

WHEREAS, in accordance with the requirements of Section 99.430 of the Statute, this Board placed a public notice in a newspaper of general circulation in the City that a public hearing would be held by this Board on the Plan, and a hearing was held at the time and place designated in that notice and all those who were interested in being heard were given a reasonable opportunity to express their views; and

WHEREAS, it is necessary that this Board take appropriate official action respecting the approval of the Plan.

NOW, THEREFORE, BE IT ORDAINED BY THE CITY OF ST. LOUIS AS FOLLOWS:

SECTION ONE. There exists within the City of St. Louis ("City") a blighted area, as defined by Section 99.320 of the Revised Statutes of Missouri, 2000, as amended (the "Statute" being Sections 99.300 to 99.715 inclusive, as amended) described in Attachment "A", attached hereto and incorporated herein, known as the 2900 Cherokee St. Area ("Area"). The existence of deteriorated property and other conditions constitutes an economic or social liability to the City and presents a hazard to the health and well-being of its citizens. These conditions, therefore, qualify the Area as blighted within the meaning of Section 99.320(3) of the Revised Statutes of Missouri, 2000 as amended, and is evidenced by the Blighting Report attached as Exhibit "F" ("Blighting Report") to the Blighting Study and Redevelopment Plan for the Area dated March 24, 2009 which is attached hereto, and labeled Attachment "B" and incorporated herein by reference ("Plan").

SECTION TWO. The redevelopment of the Area, as provided by the Statute, is necessary and in the public interest, and is in the interest of the public health, safety, morals and general welfare of the people of the City.

SECTION THREE. The Area qualifies as a redevelopment area in need of redevelopment under the provision of the Statute, and the Area is blighted as defined in Section 99.320 of the Statute.

SECTION FOUR. The Plan (including the Blighting Report) having been duly reviewed and considered, is hereby approved and incorporated herein by reference, and the President or Clerk of this St. Louis Board of Aldermen ("Board") is hereby directed to file a copy of the Plan with the Minutes of this meeting.

SECTION FIVE. The Plan is feasible and conforms to the general plan for the City.

SECTION SIX. The financial aid provided and to be provided for financial assistance pertaining to the Area is necessary to enable the redevelopment activities to be undertaken in accordance with the Plan, and the proposed financing plan for the Area is feasible.

SECTION SEVEN. The Plan for the Area will afford maximum opportunity, consistent with the sound needs of the City as a whole, for the redevelopment of the Area by private enterprise, and private developments to be sought pursuant to the requirements of the Statute.

SECTION EIGHT. The Plan provides that the Land Clearance for Redevelopment Authority of the City of St. Louis ("LCRA") may acquire no property in the Area by the exercise of eminent domain.

SECTION NINE. None of the property within the Area is currently occupied. If it should become occupied all eligible occupants displaced by the Redeveloper(s) ("Redeveloper(s)" being defined in Section Twelve, below) shall be given relocation assistance by the Redeveloper(s) at its expense, in accordance with all applicable federal, state and local laws, ordinances, regulations and policies.

SECTION TEN. The Plan gives due consideration to the provision of adequate public facilities.

SECTION ELEVEN. In order to implement and facilitate the effectuation of the Plan hereby approved, it is found and

determined that certain official actions must be taken by this Board and accordingly this Board hereby:

- (a) Pledges its cooperation in helping to carry out the Plan;
- (b) Requests the various officials, departments, boards and agencies of the City, which have administrative responsibilities, likewise to cooperate to such end and to execute their respective functions and powers in a manner consistent with the Plan; and
- (c) Stands ready to consider and take appropriate action upon proposals and measures designed to effectuate the Plan.

SECTION TWELVE. All parties participating as owners or purchasers of property in the Area for redevelopment ("Redeveloper(s)") shall agree for themselves and their heirs, successors and assigns that they shall not discriminate on the basis of race, color, creed, national origin, sex, marital status, age, sexual orientation or physical handicap in the sale, lease, or rental of any property or improvements erected or to be erected in the Area or any part thereof and those covenants shall run with the land, shall remain in effect without limitation of time, shall be made part of every contract for sale, lease, or rental of property to which Redeveloper(s) is a party, and shall be enforceable by the LCRA, the City and the United States of America.

SECTION THIRTEEN. In all contracts with private and public parties for redevelopment of any portion of the Area, Redeveloper(s) shall agree:

- (a) To use the property in accordance with the provisions of the Plan, and be bound by the conditions and procedures set forth therein and in this Ordinance;
- (b) That in undertaking construction under the agreement with the LCRA and the Plan, bona fide Minority Business Enterprises ("MBE's") and Women's Business Enterprises ("WBE's") will be solicited and fairly considered for contracts, subcontracts and purchase orders;
- (c) To be bound by the conditions and procedures regarding the utilization of MBE's and WBE's established by the City;
- (d) To adhere to the requirements of the Executive Order of the Mayor of the City, dated July 24, 1997, as has been extended.
- (e) To comply with applicable requirements of Ordinance No. 60275 of the City (First Source Jobs Policy, as codified at St. Louis City Revised Code Chapter 3.90);
- (f) To cooperate with those programs and methods supplied by the City with the purpose of accomplishing, pursuant to this paragraph, minority and women subcontractors and material supplier participation in the construction Pursuant to the Plan. The Redeveloper(s) will report semi-annually during the construction period the results of its endeavors under this paragraph, to the Office of the Assistant Director-Certification and Compliance of the City and the President of this Board; and
- (g) That the language of this Section Thirteen shall be included in its general construction contract and other construction contracts let directly by Redeveloper(s).

The term MBE shall mean a sole proprietorship, partnership, corporation, profit or non-profit organization owned, operated and controlled by minority group members who have at least fifty-one percent (51%) ownership. The minority group member(s) must have operational and management control, interest in capital and earnings commensurate with their percentage of ownership. The term Minority Group Member(s) shall mean persons legally residing in the United States who are Black, Hispanic, Native American (American Indian, Eskimo, Aleut or Native Hawaiian), Asian Pacific American (persons with origins from Japan, China, the Philippines, Vietnam, Korea, Samoa, Guam, U.S. Trust Territory of the Pacific Islands, Laos, Cambodia or Taiwan) or Asian Indian American (persons with origins from India, Pakistan or Bangladesh). The term WBE shall mean a sole proprietorship, partnership, corporation, profit or non-profit organization owned, operated and controlled by a woman or women who have at least fifty-one percent (51%) ownership. The woman or women must have operational and managerial control, interest in capital and earnings commensurate with their percentage of ownership.

The term "Redeveloper(s)" as used in this Section shall include successors in interest and assigns.

SECTION FOURTEEN. The Redeveloper(s) may seek ten (10) year real estate tax abatement pursuant to Sections 99.700 - 99.715, Revised Statutes of Missouri, 2000, as amended, upon application as provided therein. Such real estate tax abatement shall not include any Special Business District, Neighborhood Improvement District, Commercial Improvement District, or any other similar local taxing district created in accordance with Missouri law, whether now existing or later created.

In lieu of the ten (10) year abatement outlined above, a Redeveloper(s) which is an urban redevelopment corporation formed pursuant to Chapter 353 of the Missouri Statutes shall hereby be entitled to real property ad valorem tax abatement which shall not include any Special Business District, Neighborhood Improvement District, Commercial Improvement District or any other single local taxing district created in accordance with Missouri law, whether now existing or later created, for a total period of up to ten (10) years from the commencement of such tax abatement, in accordance with the following provisions:

If property in the Area is sold by the LCRA to an urban redevelopment corporation formed pursuant to Chapter 353 of the Missouri Statutes, or if any such corporation shall own property within the Area, then for up to the first ten (10) years after the date the redevelopment corporation shall acquire title to property in the Area, taxes on that property shall be based upon the assessment of land, exclusive of any improvements thereon, during the calendar year two (2) years prior to the calendar year during which the corporation shall have acquired title to that property. In addition to such taxes, any such corporation shall for up to the same ten (10) year period make a payment in lieu of taxes to the Collector of Revenue of the City of St. Louis in an amount based upon the assessment on the improvements located on the property during the calendar year two (2) years prior to the calendar year during which such corporation shall have acquired title to that property. If property shall be tax exempt because it is owned by the LCRA and leased to any such corporation, then such corporation for up to the first ten (10) years of the lease shall make payments in lieu of taxes to the Collector of Revenue of the City in an amount based upon the assessment on the property, including land and improvements, during the calendar year two (2) years prior to the calendar year during which such corporation shall lease that property.

All payments in lieu of taxes shall be a lien upon the property and, when paid to the Collector of Revenue of the City shall be distributed as all other property taxes. These partial tax relief and payment in lieu of taxes provisions, during up to said ten (10) year period, shall inure to the benefit of all successors in interest in the property of the redevelopment corporation, so long as such successors shall continue to use the property as provided in this Plan and in any agreement with the LCRA. In no event shall such benefits extend beyond ten (10) years after the redevelopment corporation shall have acquired title to the property.

SECTION FIFTEEN. Any proposed modification which will substantially change the Plan must be approved by this Board in the same manner as the Plan was first approved. Modifications which will substantially change the Plan include, but are not necessarily limited to, modifications on the use of eminent domain, to the length of tax abatement, to the boundaries of the Area, or to other items which alter the nature or intent of the Plan.

The Plan may be otherwise modified (e.g. urban design regulations, development schedule) by the LCRA, provided that such revisions shall be effective only upon the consent of the Planning Commission of the City.

SECTION SIXTEEN. The sections of this Ordinance shall be severable. In the event that any section of this Ordinance is found by a court of competent jurisdiction to be invalid, the remaining sections of this Ordinance are valid, unless the court finds the valid sections of the Ordinance are so essential and inseparably connected with and dependent upon the void section that it cannot be presumed that this Board would have enacted the valid sections without the void ones, or unless the court finds that the valid sections standing alone are incomplete and are incapable of being executed in accordance with the legislative intent.

EXHIBIT "A"

**2900 CHEROKEE ST. AREA
LEGAL DESCRIPTION**

C B 1576 CHEROKEE ST
23 FT 6 7/8 IN X 125 FT
CHEROKEE ADDN
LOT E-1

1576002507
2900 CHEROKEE

ATTACHMENT "B"
Form: 03/04/08

BLIGHTING STUDY AND REDEVELOPMENT PLAN
FOR THE
2900 CHEROKEE ST. AREA
PROJECT # 1401
LAND CLEARANCE FOR REDEVELOPMENT AUTHORITY
OF THE CITY OF ST. LOUIS
March 24, 2009

MAYOR
FRANCIS G. SLAY

**BLIGHTING STUDY AND REDEVELOPMENT PLAN FOR
2900 CHEROKEE ST. AREA**

	<u>PAGE</u>
A. EXISTING CONDITIONS AND FINDING OF BLIGHT	1
1. DELINEATION OF BOUNDARIES	1
2. GENERAL CONDITION OF THE AREA	1
3. PRESENT LAND USE OF THE AREA	1
4. PRESENT LAND USE AND DENSITY OF SURROUNDING PROPERTIES	2
5. CURRENT ZONING	2
6. FINDING OF BLIGHT	2
B. PROPOSED REDEVELOPMENT AND REGULATIONS	2
1. REDEVELOPMENT OBJECTIVES	2
2. PROPOSED LAND USE OF THE AREA	2
3. PROPOSED ZONING	3
4. RELATIONSHIP TO LOCAL OBJECTIVES	3
5. PROPOSED EMPLOYMENT FOR THIS AREA	3
6. CIRCULATION	3
7. BUILDING AND SITE REGULATIONS	3
8. URBAN DESIGN	4
9. PARKING REGULATIONS	5
10. SIGN REGULATIONS	5
11. BUILDING, CONDITIONAL USE AND SIGN PERMITS	5
12. PUBLIC IMPROVEMENTS	5
C. PROPOSED SCHEDULE OF REDEVELOPMENT	6
D. EXECUTION OF PROJECT	6
1. ADMINISTRATION AND FINANCING	6
2. PROPERTY ACQUISITION	6
3. PROPERTY DISPOSITION	6
4. RELOCATION ASSISTANCE	7
E. COOPERATION OF THE CITY	7

F. TAX ABATEMENT 7

G. COMPLIANCE WITH AFFIRMATIVE ACTION AND NONDISCRIMINATION LAWS AND REGULATIONS 8

 1. LAND USE 8

 2. CONSTRUCTION AND OPERATIONS 8

 3. LAWS AND REGULATIONS 8

 4. ENFORCEMENT 8

H. MODIFICATIONS OF THIS PLAN 9

I. DURATION OF REGULATION AND CONTROLS 9

J. EXHIBITS 9

K. SEVERABILITY 9

EXHIBITS

- "A" LEGAL DESCRIPTION
- "B" PROJECT AREA PLAN
- "C" PROPOSED LAND USE
- "D" ACQUISITION MAP
- "E" EQUAL OPPORTUNITY AND NON-DISCRIMINATION GUIDELINES
- "F" BLIGHTING REPORT

A. EXISTING CONDITIONS AND FINDINGS OF BLIGHT

1. DELINEATION OF BOUNDARIES

The 2900 Cherokee St. Redevelopment Area ("Area") encompasses approximately 0.07 acres in the Gravois Park Neighborhood of the City of St. Louis ("City") and is located on the south side of Cherokee St. between Nebraska Ave. and Pennsylvania Ave.

The legal description of the Area is attached and labeled Exhibit "A". The boundaries of the Area are delineated on Exhibit "B" ("Project Area Plan").

2. GENERAL CONDITION OF THE AREA

The Area comprises a portion of City Block 1576. The Area is in poor condition. The parcel by parcel physical conditions within the Area are shown on Exhibit "B" (Project Area Plan) and enumerated in Exhibit "F" (Blighting Report).

Unemployment figures, computed by the Missouri State Employment Service, indicate an 8.2% unemployment rate for the City as of December, 2008. It is estimated that this rate is prevalent for residents of the neighborhoods surrounding the Area.

There are currently no jobs within the Area.

3. PRESENT LAND USE OF THE AREA

Existing land uses within the Area include one unoccupied mixed-use building.

The land use, including the location of public and private uses, streets and other rights-of-way, is shown on

Exhibit "B".

4. PRESENT LAND USE AND DENSITY OF SURROUNDING PROPERTIES

The properties surrounding the Area are primarily used for residential and commercial purposes.

Residential density for the surrounding neighborhoods is approximately 20.69 persons per acre.

5. CURRENT ZONING

The Area is currently zoned "G" Local Commercial and Office District pursuant to the Zoning Code of the City, which is incorporated in this Plan by reference.

6. FINDING OF BLIGHT

The property within the Area is unoccupied and in the conditions outlined in Exhibit "F". The existence of deteriorated property constitutes an economic or social liability to the City and presents a hazard to the health and well-being of its citizens. The preponderance of properties in the Area has been determined to be blighted within the meaning of Section 99.300 *et seq.* of the Revised Statutes of Missouri (the Land Clearance for Redevelopment Authority Law) as evidenced by the Blighting Report attached hereto, labeled Exhibit "F" and incorporated herein by this reference.

B. PROPOSED DEVELOPMENT AND REGULATIONS

1. DEVELOPMENT OBJECTIVES

The primary objectives of this Plan are to eliminate blight within the Area and to facilitate the redevelopment of the Area into productive residential uses.

2. PROPOSED LAND USE OF THE AREA

The proposed land uses for the Area are residential uses permitted in Areas designated "B" Two Family Residential District by the City of St. Louis Zoning Code. Redeveloper(s) authorized by the Land Clearance for Redevelopment Authority of the City of St. Louis ("LCRA") to develop property in the Area (hereafter referred to as "Redeveloper(s)") shall be permitted to use said property for the above proposed uses and for commercial uses provided that a zoning variance is obtained from the City of St. Louis Board of adjustment.

Any person or entity seeking an occupancy permit for a new use after the effective date of the ordinance approving the Plan shall not be permitted to use said property for the following:

pawn shops; adult bookstores; X-rated movie houses; massage parlors (unless licensed by the State of Missouri); health spas; auto and truck dealers (new or used); storefront churches; pinball and video arcades, pool halls, secondhand or junk shops, tattoo or piercing parlors, barber shops or beauty salons that allow outdoor loitering; truck or other equipment rentals requiring outside storage; blood donor facilities; package liquor stores; establishments selling or providing liquor and not having gross sales of at least 50% from food items at that location; restaurants which do not have indoor table service with at least 12 chairs and 3 tables or the equivalent and which carry out outdoor sales, distribution, displays, or food preparation in the public right of way; convenience stores (including grocery stores that do not have refrigeration, fresh fruits and vegetables, dairy products, and bread); laundromat or cleaners dropoff without a paid attendant employee; exterior telephones; lottery ticket sales; cigarette, cigar, or smoke shop; check cashing centers; title loans; rent-to-own stores; any use that utilizes a sales or service window or facility for customers who are walking or in vehicles, or restaurants that sell products to customers who are in cars or who consume the sold products in cars parked on the restaurant premises or sell products through a sales window to customers who are in cars or to pedestrians outside the building for immediate consumption by the customer either on or off the premises; open storage; automobile, truck, or motorized vehicle service facilities; motor fuel pumping stations; detailing or car washes; dyeing and cleaning works; private clubs and lodges; rooming and boarding houses; utility stations; utility towers; nail shops; beeper or pager shops; and billboards and signs in excess of City ordinance allowance for the business.

Exhibit "C" (Proposed Land Use) shows the proposed uses for the Area. The 2009 Strategic Land Use Plan designated it as a Neighborhood Preservation Area (NPA).

3. PROPOSED ZONING

The zoning for the Area can remain "G" Local Commercial and Office District. All land coverage and building intensities shall be governed thereby.

4. RELATIONSHIP TO LOCAL OBJECTIVES

The proposed land uses, zoning, public facilities and utility plans are appropriate and consistent with local objectives as defined by the General Plan of the City of St. Louis which includes the "Strategic Land Use Plan of the City of St. Louis" (2005). Any specific proposal to the LCRA for redevelopment of the Area or any portion of the Area shall contain, among other things, adequate provisions for traffic, vehicular parking, safety from fire, adequate provisions for light and air, sound design and arrangement and improved employment opportunities.

5. PROPOSED EMPLOYMENT FOR THIS AREA

No new jobs will be created in this Area because the proposed redevelopment is residential.

6. CIRCULATION

The Proposed Land Use Plan (Exhibit "C") indicates the proposed circulation system for the Area. The layouts, levels and grades of all public rights-of-way may remain unchanged except for the vacation of the alley in the block.

Rights-of-way changes will be subject to the review and approval of the City Department of Streets, and all vacations of rights-of-way are subject to approval by ordinance.

7. BUILDING AND SITE REGULATIONS

The Area shall be subject to all applicable federal, state and local laws, ordinances, regulations and codes, including but not limited to, the City Building Code, Zoning District Regulations, and stipulations of the Planning and Urban Design Agency ("PDA") of the City. The population densities, land coverage, and building intensities of redevelopment shall be governed by the Zoning Code. No changes in the building codes or ordinances are required.

A Redeveloper(s) shall redevelop the Area in accordance with this Plan and the redevelopment agreement (if any) ("Agreement"), and shall maintain all structures, equipment, paved areas, and landscaped areas controlled by the Redeveloper(s) in good and safe order both inside and outside, structurally and otherwise, including necessary and proper painting. Failure to meet these requirements may result in suspension of tax abatement.

8. URBAN DESIGN

a. **Urban Design Objectives**

The property shall be redeveloped such that it is an attractive residential asset to the surrounding neighborhood.

b. **Urban Design Regulations**

- 1.) **Rehabilitation** shall respect the original exterior in terms of design and materials. Window and door shapes and detailing shall be compatible with the original design. There shall be no barring, boarding, or covering of windows. There shall be installation of all new mechanical systems (HVAC, electrical, and plumbing) that meet current building codes of the City.

- 2.) **New construction** or alterations shall be positioned on their lot so that any existing recurrent building masses and spaces are continued as well as the pattern of setback from the street.
- 3.) **Exterior Materials** All new building materials on facades visible from the street(s) shall be compatible in type and texture with the dominant materials of adjacent buildings. Artificial masonry such as "Permastone" is not permitted. A submission of all building materials shall be required prior to approval.
- 4.) **Architectural Details** on existing structures shall be maintained in a similar size, detail and material. Where they are badly deteriorated, similar details salvaged from other buildings may be substituted. Both new and replacement window and doorframes shall be limited to wood or color finished aluminum on the street facing facades, including basement windows. Raw or unfinished aluminum and glass block are not acceptable. Awnings of canvas only are acceptable.
- 5.) **Roof Shapes.** When one roof shape is employed in a predominance of existing buildings in a block, any proposed new construction or alteration should be viewed with respect to its compatibility with the existing adjacent buildings.
- 6.) **Roof Materials** shall be slate, tile, copper or asphalt shingles where the roof is visible from the street. Brightly colored asphalt shingles are not appropriate.

c. Landscaping

The property shall be well-landscaped. Perimeter street trees of a minimum caliper of 2-1/2 inches and generally 30-35 feet on center as determined by the Parks Department of the City, depending upon tree type, utilities, curb cuts, etc., shall be provided along all public or private streets - preferably in tree lawns along the curb. If necessary, sidewalks shall be notched to accommodate the trees.

Ornamental or shade trees should be provided in the front lawns along with evergreen accent shrubs.

Existing, healthy trees shall be retained, if feasible.

d. Fencing

Fencing in the front yards shall be limited to ornamental metal with a black matte finish. Fencing behind the building line and not facing a street may be chain link with a black matte finish, or a good quality, privacy fence provided it is not wood stockade style. Fencing facing a side street shall be ornamental metal or a good quality board fence up to six (6) feet in height provided landscaping is provided between the fence and the sidewalk.

9. **PARKING REGULATIONS**

Parking shall be provided in accordance with the applicable zoning and building code requirements of the City, including PDA standards. This will provide adequate vehicular parking for the Area.

Where feasible, parking shall be limited to the rear of the property off the alley, and at least one space shall be provided for each residential unit. In addition, surface parking shall not extend beyond the established building line. Surface parking along public streets shall be buffered by a continuous evergreen hedge at least two and one-half (2 ½) feet high on planting and maintained at three and one-half (3 ½) feet high at maturity.

10. **SIGN REGULATIONS**

All new signs shall be limited as set out in the City Code, PDA stipulations, this Plan and agreements between the LCRA and the Redeveloper(s). All new signs shall be restricted to standard sale/lease signs.

11. BUILDING, CONDITIONAL USE AND SIGN PERMITS

No building, conditional use, or sign permits shall be issued by the City without the prior written approval of the LCRA.

12. PUBLIC IMPROVEMENTS

No additional schools, parks, recreational and community facilities or other public facilities will be required. Additional water, sewage or other public utilities may be required depending on development. The cost of such utility improvements will be borne by the Redeveloper(s).

If funds are available to the LCRA, it may provide public improvements including, but not limited to, measures for the control of traffic, improvements to street lighting, street trees, and any other improvements which may further the objectives of this Plan.

When developed in accordance with this Plan, the Area will comprise a coordinated, adjusted and harmonious redevelopment that promotes the health, safety, morals, order, convenience, prosperity, general welfare, efficiency and economy of the City.

C. PROPOSED SCHEDULE OF REDEVELOPMENT

The implementation of this Plan shall take place in a single phase initiated within approximately one (1) year of approval of this Plan by ordinance and completed within approximately two (2) years of approval of this Plan by ordinance.

The LCRA may alter the above schedule as economic conditions warrant.

D. EXECUTION OF PROJECT1. ADMINISTRATION AND FINANCING

The LCRA is empowered by Missouri law to administer redevelopment of all types pursuant to this Plan and can do so to the extent and in the manner prescribed by the Land Clearance for Redevelopment Authority Law of Missouri.

All costs associated with the redevelopment of the Area will be borne by the Redeveloper(s).

Implementation of this Plan may be financed by funds obtained from private and/or public sources, including, without limitation, revenue bonds, bank loans, and equity funds provided by the Redeveloper(s). The Redeveloper must obtain State of Missouri Historic Tax Credits.

2. PROPERTY ACQUISITION

The Property Acquisition Map, Exhibit "D" attached, identifies all the property located in the Area. The LCRA may not acquire any property in the Area by the exercise of eminent domain.

3. PROPERTY DISPOSITION

If the LCRA acquires property in the Area, it may sell or lease the property to Redeveloper(s) who shall agree to redevelop such property in accordance with this Plan and the Agreement between such Redeveloper(s) and the LCRA. Any property acquired by the LCRA and sold to Redeveloper(s) will be sold at not less than its fair value, taking into account and giving consideration to those factors enumerated in Section 99.450, R.S.Mo. (2000) as amended, for uses in accordance with this Plan.

4. RELOCATION ASSISTANCE

The property within the Area is currently unoccupied. If it should become occupied, all eligible occupants displaced as a result of the implementation of the Plan shall be given relocation assistance in accordance with

all applicable federal, state and local laws, ordinances, regulations and policies.

E. COOPERATION OF THE CITY

The City and its Board of Aldermen, by enacting an ordinance approving this Plan, pledges its cooperation to enable the project to be carried out in a timely manner and in accordance with this Plan.

F. TAX ABATEMENT

Redeveloper(s) may seek ten (10) year real estate tax abatement pursuant to Sections 99.700 - 99.715, Revised Statutes of Missouri, 2000, as amended, upon application as provided therein. Such real estate tax abatement shall not include taxes collected for any Special Business District, Neighborhood Improvement District, Commercial Improvement District, or any other similar local taxing district created in accordance with Missouri law, whether now existing or later created.

In lieu of the ten (10) year abatement outlined above, Redeveloper(s) which is an urban redevelopment corporation formed pursuant to Chapter 353 of the Missouri Statutes shall hereby be entitled to real property ad valorem tax abatement which shall not include taxes collected for any Special Business District, Neighborhood Improvement District, Commercial Improvement District, or any other single local taxing district created in accordance with Missouri law, whether now existing or later created, for a total period of up to ten (10) years from the commencement of such tax abatement, in accordance with the following provisions:

If property in the Area is sold by the LCRA to an urban redevelopment corporation formed pursuant to Chapter 353 of the Missouri Statutes, or if any such corporation shall own property within the Area, then for up to the first ten (10) years after the date the redevelopment corporation shall acquire title to property in the Area, taxes on that property shall be based upon the assessment of land, exclusive of any improvements thereon, during the calendar year two (2) years prior to the calendar year during which the corporation shall have acquired title to the property. In addition to such taxes, any such corporation shall for up to the same ten (10) year period make a payment in lieu of taxes to the Collector of Revenue of the City of St. Louis in an amount based upon the assessment on the improvements located on the property during the calendar year two (2) years prior to the calendar year during which such corporation shall have acquired title to that property. If property shall be tax exempt because it is owned by the LCRA and leased to any such corporation, then such corporation for up to the first ten (10) years of the lease shall make payments in lieu of taxes to the Collector of Revenue of the City in an amount based upon the assessment on the property, including land and improvements, during the calendar year two (2) years prior to the calendar year during which such corporation shall lease that property.

All payments in lieu of taxes shall be a lien upon the property and, when paid to the Collector of Revenue of the City shall be distributed as all other property taxes. These partial tax relief and payment in lieu of taxes provisions, during up to said ten (10) year period, shall inure to the benefit of all successors in interest in the property of the redevelopment corporation, so long as such successors shall continue to use the property as provided in this Plan and in any Agreement with the LCRA. In no event shall such benefits extend beyond ten (10) years after the redevelopment corporation shall have acquired title to the property.

G. COMPLIANCE WITH AFFIRMATIVE ACTION AND NONDISCRIMINATION LAWS AND REGULATIONS

1. LAND USE

A Redeveloper(s) shall not discriminate on the basis of race, color, creed, national origin, marital status, sex, age, sexual orientation or physical handicap in the lease, sale or occupancy of the Area.

2. CONSTRUCTION AND OPERATIONS

A Redeveloper(s) shall not discriminate on the basis of race, color, creed, national origin, marital status, sex, age, sexual orientation or physical handicap in the construction and operation of any project in the Area and shall take such affirmative action as may be appropriate to afford opportunities to everyone in all activities of the project, including enforcement, contracting, operating and purchasing.

3. LAWS AND REGULATIONS

A Redeveloper(s) shall comply with all applicable federal, state and local laws, ordinances, executive orders and regulations regarding nondiscrimination and affirmative action, including the City Guidelines for Minimum Utilization of Minority Enterprises, dated January 1, 1981 as may be amended, and the "Equal Opportunity and Nondiscrimination Guidelines" in Exhibit "E", attached.

4. ENFORCEMENT

All of the provisions of this Section G shall be incorporated in an Agreement between the LCRA and a Redeveloper(s), which Agreement shall be recorded in the office of the Recorder of Deeds. The provisions of G (1) and G (3) shall be covenants running with the land, without limitation as to time, and the provisions of G (2) shall be for the duration of this Plan and any extension thereof.

All of the provisions of Section G shall be enforceable against the Redeveloper(s), its heirs, successors or assigns, by the LCRA, the City, any state having jurisdiction or the United States of America.

H. MODIFICATIONS OF THIS PLAN

Any proposed modification which will substantially change this Plan shall be approved by the St. Louis Board of Aldermen in the same manner as this Plan was first approved. Modifications which will substantially change this Plan include, but are not necessarily limited to, modifications on the use of eminent domain, to the length of tax abatement, to the boundaries of the Area, to the proposed land uses, to the proposed zoning, to the urban design regulations, to the use of Missouri Historic Tax Credits, or other items which alter the nature or intent of this Plan.

This Plan may be otherwise modified (e.g. urban design regulations, development schedule) by the LCRA, provided that such revisions shall be effective only upon the consent of the PDA.

I. DURATION OF REGULATION AND CONTROLS

The regulation and controls set forth in this Plan shall be in full force and effect for twenty-five years commencing with the effective date of approval of this Plan by ordinance, and for additional ten (10) year periods unless before the commencement of any such ten (10) year period the St. Louis Board of Aldermen shall terminate this Plan as of the end of the term then in effect, except as provided in Section G (4) of this Plan.

J. EXHIBITS

All attached exhibits are hereby incorporated by reference into this Plan and made a part hereof.

K. SEVERABILITY

The elements of this Plan satisfy all requirements of state and local laws. Should any provisions of this Plan be held invalid by a final determination of a court of law, the remainder of the provisions hereof shall not be affected thereby, and shall remain in full force and effect.

EXHIBIT "A"

**2900 CHEROKEE ST. AREA
LEGAL DESCRIPTION**

C B 1576 CHEROKEE ST
23 FT 6 7/8 IN X 125 FT
CHEROKEE ADDN
LOT E-1

15760002507
2900 CHEROKEE

See attached Exhibits B, C & D

EXHIBIT "E"
FORM: 02/08/08

EQUAL OPPORTUNITY AND NONDISCRIMINATION GUIDELINES

In any contract for work in connection with the redevelopment of any property in the Area, the Redeveloper(s) (which term shall include Redeveloper(s), any designees, successors and assigns thereof, any entity formed to implement the project of which the Redeveloper(s) is affiliated), its contractors and subcontractors shall comply with all federal, state and local laws, ordinances, or regulations governing equal opportunity and nondiscrimination (Laws). Moreover, the Redeveloper(s) shall contractually require its contractors and subcontractors to comply with such laws.

The Redeveloper(s) and its contractor will not contract or subcontract with any party known to have been found in violation of any such Laws, ordinances, regulations or these guidelines.

The Redeveloper(s) shall fully comply with Executive Order #28 dated July 24, 1997, as has been extended, relating to minority and women-owned business participation in City contracts.

The Redeveloper(s) agrees for itself and its successors and assigns, that there shall be covenants to ensure that there shall be no discrimination on the part of the Redeveloper(s), its successors or assigns upon the basis of race, color, creed, national origin, sex, marital status, age, sexual orientation or physical handicap in the sale, lease, rental, use or occupancy of any property, or any improvements erected or to be erected in the Area or any part thereof, and those covenants shall run with the land and shall be enforceable by the LCRA, the City, and the United States of America, as their interests may appear in the project.

Redeveloper(s) shall fully comply (and ensure compliance by "anchor tenants") with the provisions of St. Louis City Ordinance #60275 (First Source Jobs Policy) which is codified at Chapter 3.90 of the Revised Ordinances of the City of St. Louis.

EXHIBIT "F"

**Blighting Report for the
2900 Cherokee St. Redevelopment Area**

As outlined below, the Area suffers from a multitude of physical and economic deficiencies including defective and inadequate streets, insanitary or unsafe conditions, deterioration or inadequate site improvements, improper subdivision or absolute platting and conditions which endanger life or property by fire or other curses.

As a result of these factors the preponderance of the property in the Area is an economic liability for the City, its residents and the taxing districts that depend upon it as a revenue source, as well as a sound, health safety liability. It, therefore, qualifies as a "blighted area" as such time is defined in Section 99.320(3) of the Missouri Revised Statute (2000) as amended.

Subject Property is: _____ vacant land unoccupied residential
_____ unoccupied/occupied commercial

Subject Property is: secured _____ unsecured

The subject property _____ has _____ has not a predominance of defective or inadequate streets
If answer is yes, explain: _____

The subject property has _____ has not insanitary or unsafe conditions
If answer is yes, explain: The property is unoccupied. As such, it is subject to illegal dumping, rat infestation, and use by transients. It is also a fire hazard.

The subject property has _____ has not deterioration of site conditions
If answer is yes, explain: Back wall is missing. Mortar is missing, the roof needs replacement, as do all mechanical systems.

The subject property _____ has has not improper subdivision or absolute platting

If answer is yes, explain: _____

The subject property _____X_____ has _____ has not conditions which endanger life or property by fire or other cause. If answer is yes, explain: The building is unoccupied, consequently it is subject to illegal dumping and use by transients, which combine to make it a significant fire risk.

The subject property _____ does _____X_____ does not retard the provision of housing accommodations
If answer is yes, explain: _____

The subject property _____X_____ does _____ does not constitute an economic liability
If answer is yes, explain: The building is unoccupied and significantly deteriorated. It drags down the value of surrounding properties and would take significant investment to bring up to code.

The subject property _____ does _____X_____ does not constitute a social liability
If answer is yes, explain: _____

The subject property _____X_____ is _____ is not a menace to the public health, safety, morals or welfare in its present condition and use. If answer is yes, explain: The building is unoccupied and subject illegal dumping, rat infestation, and fire.

The subject property _____X_____ is _____ is not detrimental because of dilapidation, deterioration, age or obsolescence. If answer is yes, explain: The building is significantly deteriorated, with the deteriorated site conditions listed above.

The subject property _____ is _____X_____ is not detrimental because of lack of air sanitation or open space. If answer is yes, explain: _____

The subject property _____ is _____X_____ is not detrimental because of high density of population.
If answer is yes, explain: _____

The subject property _____ is _____X_____ is not detrimental because of overcrowding of buildings, overcrowding of land. If answer is yes, explain: _____

The subject property _____X_____ has _____ has not a combination of factors that are conducive to ill health, transmission of disease, infant mortality, juvenile delinquency, and . If answer is yes, explain: The unoccupied building is subject to illegal dumping and rat infestation. It is also subject to use by transients and as an unsafe play areas by neighborhood children.

Approved: June 9, 2009

ORDINANCE NO. 68367 – EXHIBIT B

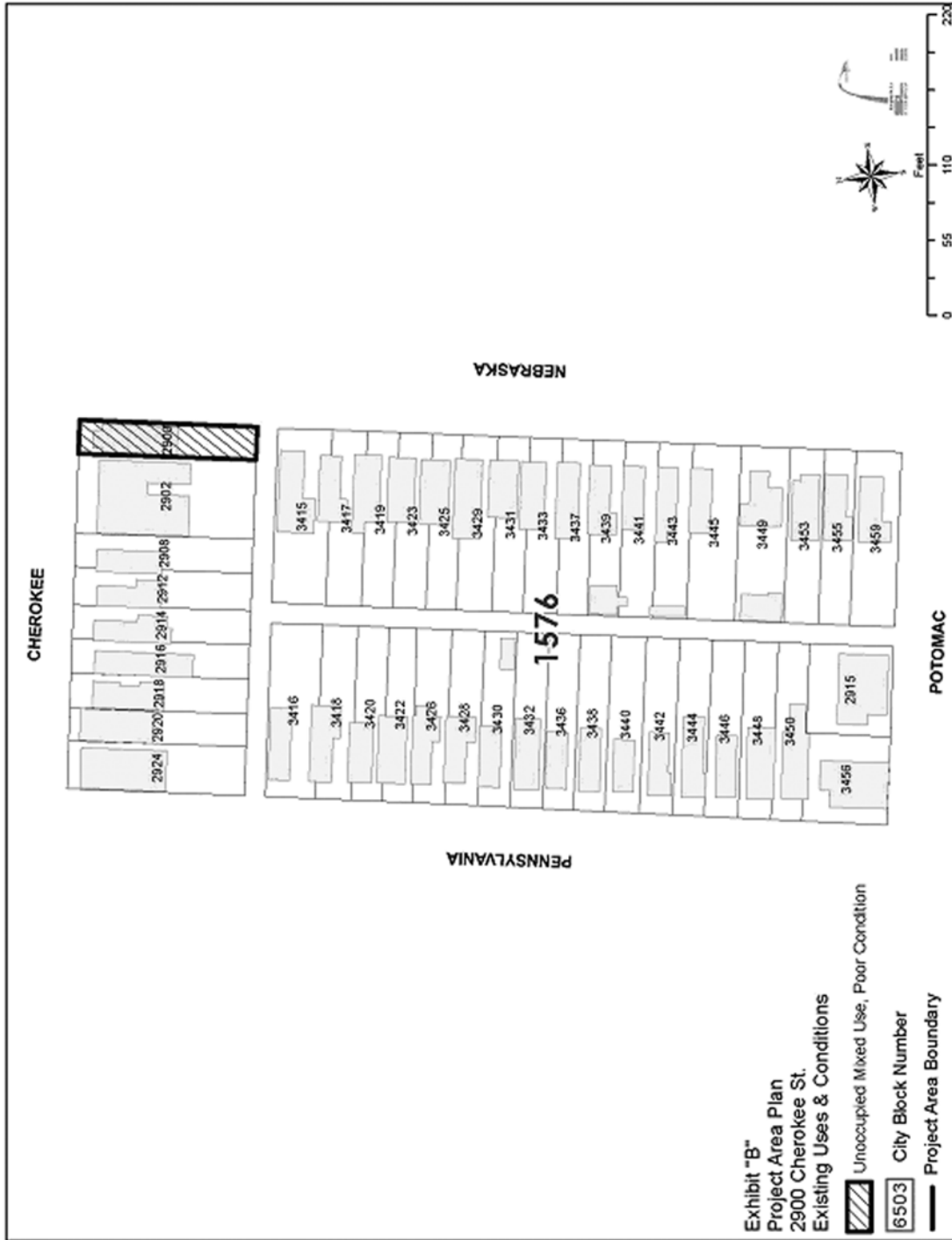

ORDINANCE NO. 68367 – EXHIBIT C

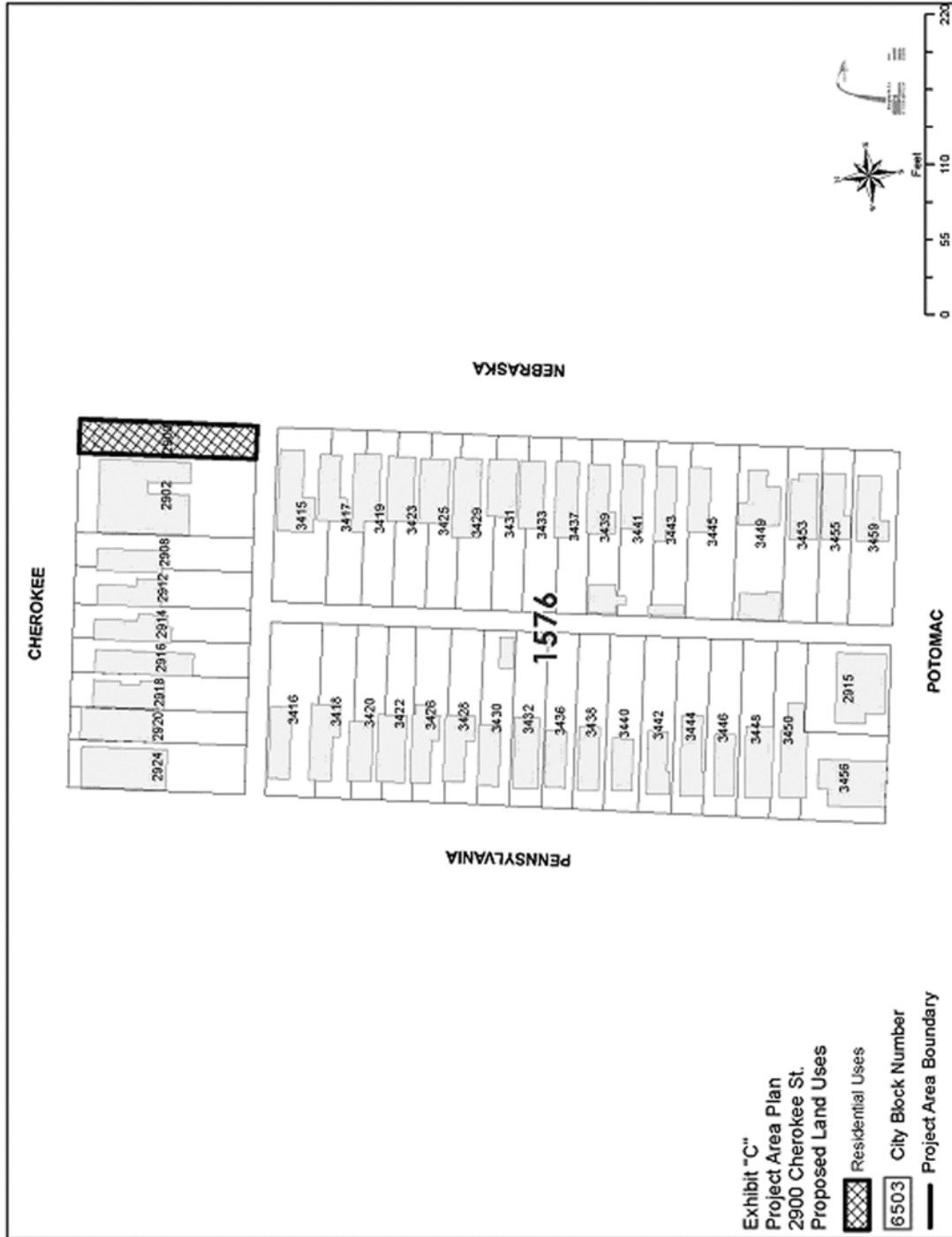

ORDINANCE NO. 68367 – EXHIBIT D

