

2 ROOM 129 - PROPOSED LAYOUT
SCALE : 1/4" = 1'-0"

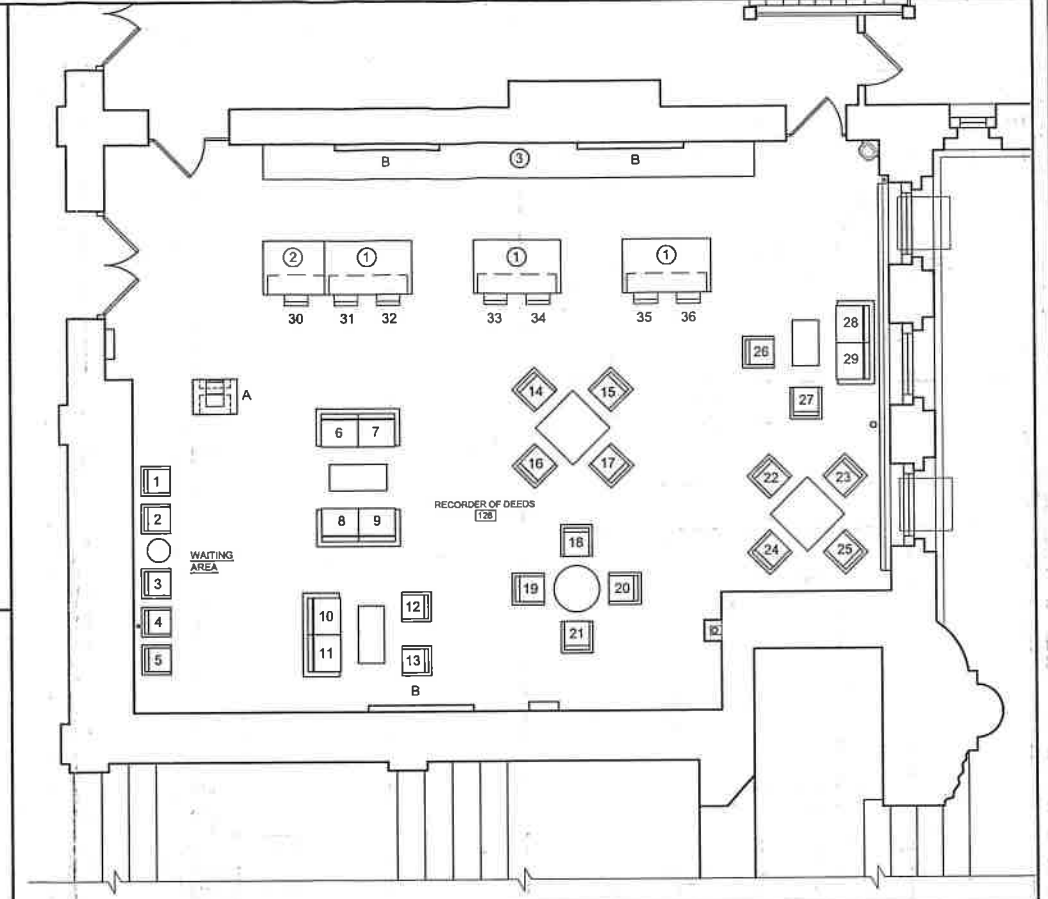

1 ROOM 128 - RECORDER OF DEEDS - PROPOSED LAYOUT
SCALE : 1/4" = 1'-0"

- FURNITURE LEGEND**
- ① SERVICE COUNTER
 - ② SERVICE COUNTER (ADA HEIGHT)
 - ③ COUNTER W/ LOCKABLE CABINETS BELOW
 - ④ OPEN SHELVING / STORAGE
 - ⑤ MICROFILM STORAGE CABINETS
 - ⑥ COUNTER WITH CABINETS BELOW AND OPEN SHELVING ABOVE
 - ⑦ COUNTER WITH STORAGE BELOW
 - ⑧ CONTINUOUS COUNTER
- EQUIPMENT LEGEND**
- A SIGN-IN RACK
 - B WALL MOUNTED DIGITAL DISPLAY
 - C MICROFILM SCANNING STATION
 - D LASER JET PRINTER
 - E MICRO FORM READER SCANNER (ABOVE)
 - F PRINTER (BELOW)
 - G LARGE FORMAT PRINTER
 - H PRINTER
 - J PAPER SHREDDER
 - K WORK STATION (MONITOR, KEYBOARD, CPU)
 - L IT

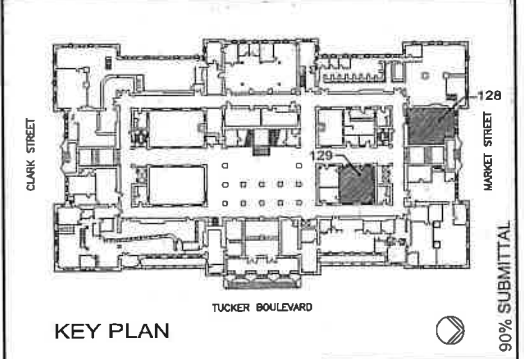

KEY PLAN

90% SUBMITTAL

DRAWING ISSUE	
<input checked="" type="checkbox"/>	01/06/21 Progress Drawings
<input type="checkbox"/>	Issued for Bidding
<input type="checkbox"/>	Issued for Permit
<input type="checkbox"/>	Issued for Construction

BPS Project No. R-2020-00-078

SEAL

Karl A. Grice A-4715
Seal Proponent

CUSTOM ENGINEERING, INC.
MECHANICAL & ELECTRICAL ENGINEERING
304 NORTH BROADWAY SUITE 2018
ST. LOUIS, MISSOURI 63102 (314) 386-3360

Grice Group Architects
314.535.4826
4332 Lindell Boulevard
Saint Louis, Missouri 63108-2702

SHEET TITLE: FURNITURE / EQUIPMENT PLAN
INTERIOR ALTERATIONS:
**CITY OF ST. LOUIS
RECORDER OF DEEDS**
ST. LOUIS CITY HALL RMS. 128 AND 129
1209 MARKET STREET ST. LOUIS, MO 63103

WHEN THIS DRAWING IS REPRODUCED AT ORIGINAL SCALE THIS BAR = 1 INCH

1 INCH

REVISIONS	
DATE	DESCRIPTION

PROJECT NO:
2007-09

DATE:

SHEET NO:
FE1.1